

THIS DRAWING IS UNPUBLISHED. RELEASED FOR PUBLICATION, 19 .  
 © COPYRIGHT 19 BY AMP INCORPORATED. ALL INTERNATIONAL RIGHTS RESERVED.

| LOC |    | DIST |  | P |  | F    |     | REVISIONS                      |         | DATE | APPD |
|-----|----|------|--|---|--|------|-----|--------------------------------|---------|------|------|
| G   | 14 |      |  |   |  | ZONE | LTR | DESCRIPTION                    |         |      |      |
|     |    |      |  |   |  |      | C   | REV & REDRAWN PER 0720-0061-93 | 4-19-93 | APPD |      |

**METRIC**  
 DIMENSIONS LISTED IN mm [ INCHES ]

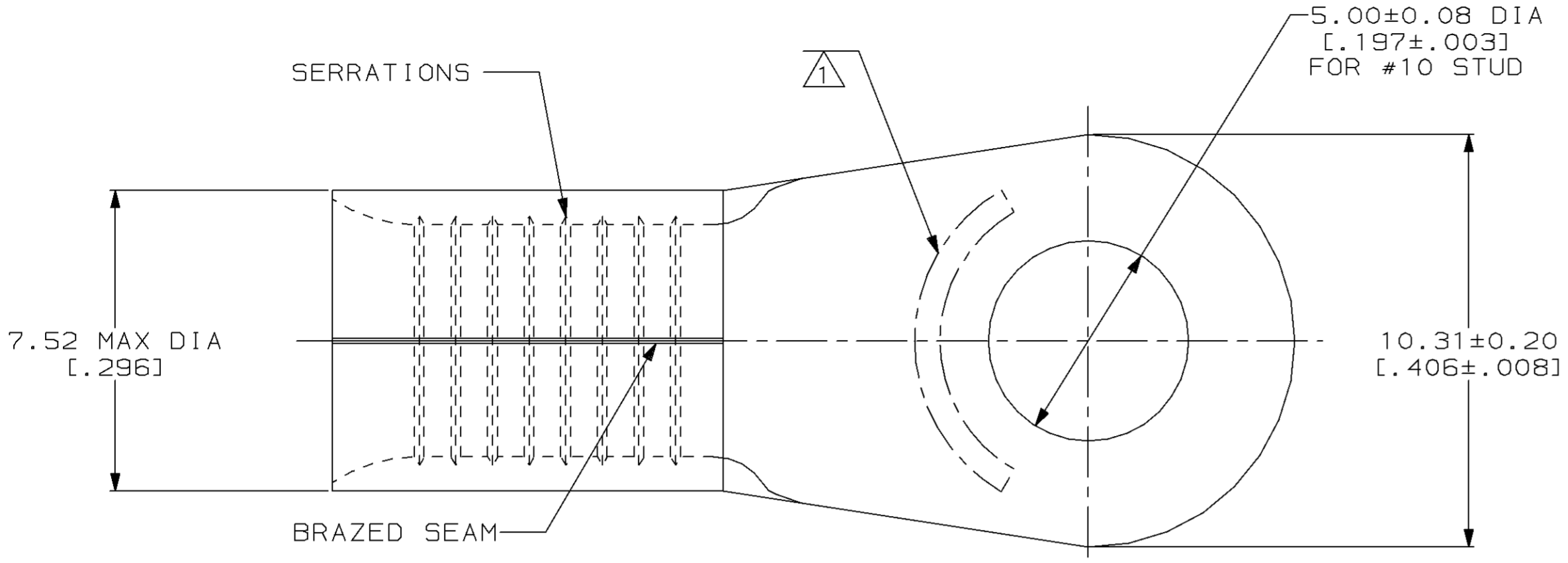

|                               |                           |
|-------------------------------|---------------------------|
| <b>AMP</b><br>WIRE RANGE      | <b>UL</b> Listed          |
| 8 AWG<br>SOLID OR STRANDED    | NOT<br>APPLICABLE         |
| <b>SR</b> LR7189<br>Certified | MILITARY P/N<br>AND CLASS |
| NOT<br>APPLICABLE             | NOT<br>APPLICABLE         |

1 STAMP AMP 8\* APPROX AS SHOWN

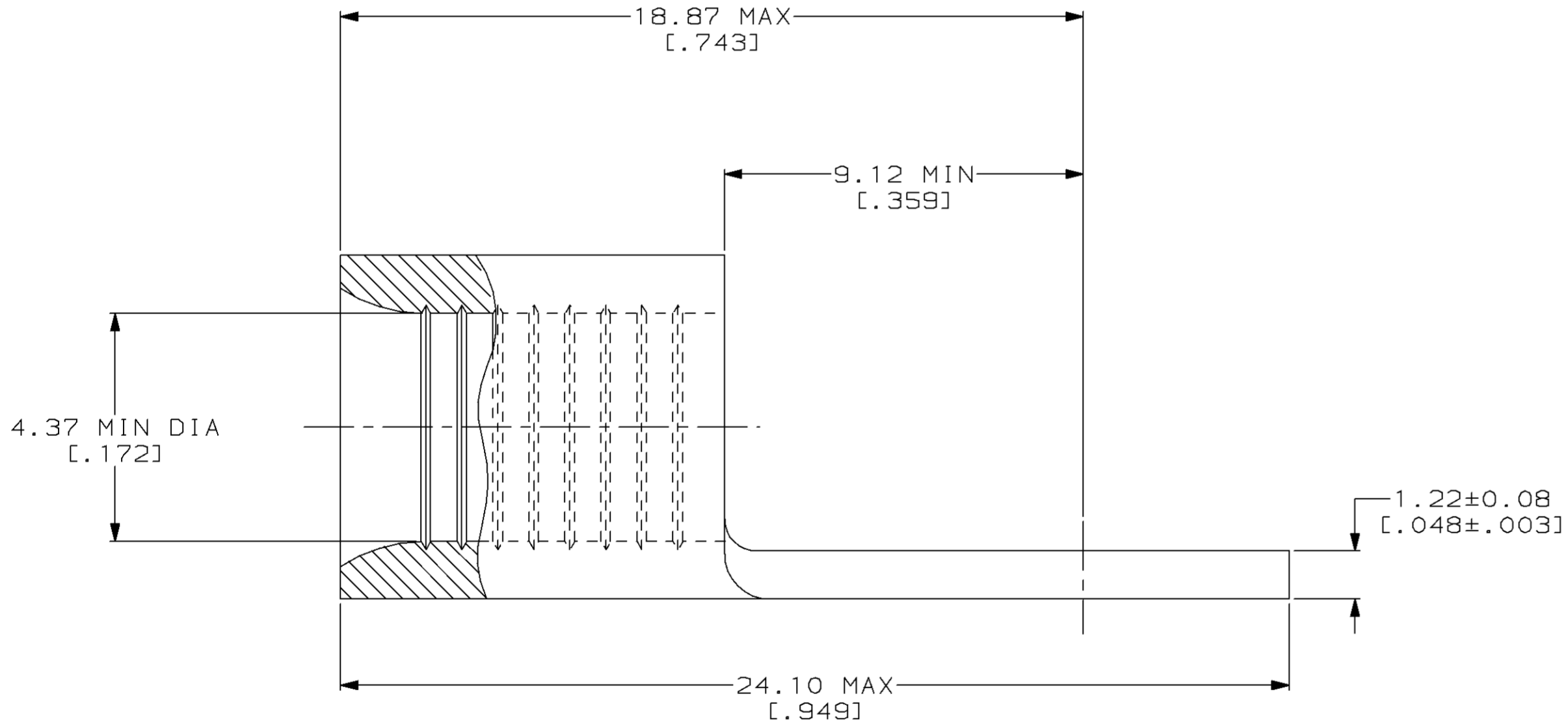

|   |  |  |  |                             |  |
|---|--|--|--|-----------------------------|--|
| AMP INCORPORATED<br>CUSTOMER SERVICE SYSTEMS  |  | MAX RECOMMENDED OPERATING TEMPERATURE:<br>343°C MAX  | DO NOT SCALE PRINT.<br>UNLESS SPECIFIED<br>DIMENSIONS IN mm [INCHES]<br>TOLERANCES ON:<br>2 PLC DEC ± -<br>3 PLC DEC ± -<br>ANGLES ± - | DR 4-19-93<br>TA BRINKMAN   | <b>AMP</b> AMP Incorporated<br>Harrisburg, PA 17105-3608 |
| FOR ADDITIONAL<br>PRODUCT INFORMATION OR<br>COPIES OF DRAWINGS<br>AND TECHNICAL DOCUMENTS | PRODUCT INFORMATION CENTER<br>1-800-522-6752 | VOLTAGE RATING:<br>NOT APPLICABLE  | MATERIAL<br>COPPER PER<br>ASTM B-152<br>ANNEALED   | CHK 4-19-93<br>DA PATTERSON |  |
| FOR APPLICATION<br>TOOLING INFORMATION  | TOOLING ASSISTANCE CENTER<br>1-800-722-1111  | WIRE CROSS SECTIONAL AREA RANGE:<br>6.64-10.5MM² [13,100-20,800] CIR MILS<br>SOLID OR STRANDED   | FINISH<br>NICKEL PLATE<br>0.00762[0.000300] MIN<br>THK PER QQ-N-290  | APPD 4-19-93<br>DE MILLER   | SIZE<br>00779  |
| FOR ORDER ENTRY   | 1-800-526-5142                               | THIS DRAWING IS A CONTROLLED DOCUMENT FOR<br>AMP INCORPORATED. IT IS SUBJECT TO CHANGE<br>AND THE CONTROLLING ENGINEERING ORGANIZATION<br>SHOULD BE CONTACTED FOR THE LATEST REVISION. |  | APPD 4-19-93<br>JL MECKLEY  | DRAWING NO<br>C=323165                                   |
|   |  |  |  | PRODUCT SPEC<br>-           | SCALE<br>8:1   |
|   |  |  |  | APPLICATION SPEC<br>-       | SHEET<br>1 OF 1  |
|   |  |  |  | WEIGHT<br>-                 |  |